

BD PureWick™ Urine Collection System

Quick setup guide

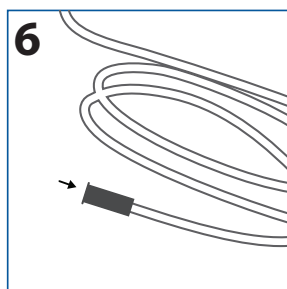
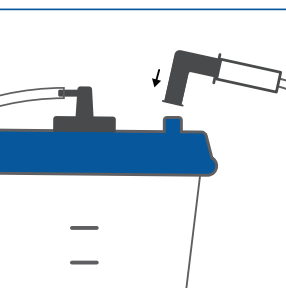
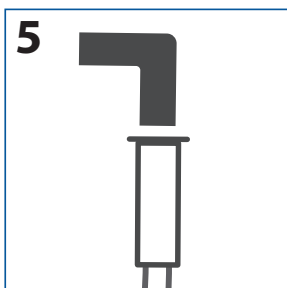
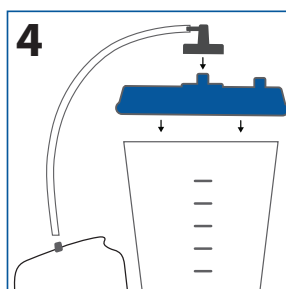
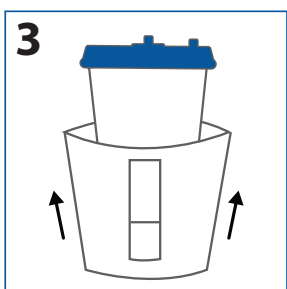
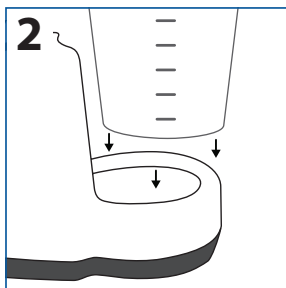
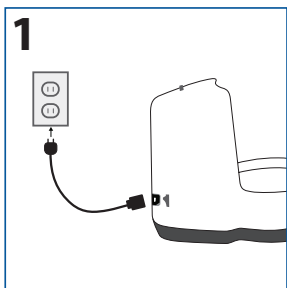

1. Plug power cord into device outlet and into the A/C power outlet. Note: Make sure the power switch is turned off.
2. Place collection canister in the base and press down firmly on the lid making sure the lid is sealed.
3. Optional: Slip privacy cover onto the canister prior to placing canister into base.
4. Attach pump tubing to the PureWick™ Urine Collection System connector port and the connector port on the collection canister lid.
5. Attach the elbow connector to the collector tubing and connect elbow connector to the connector port on collection canister lid.
6. Connect other end of collector tubing to a PureWick™ External Catheter.